

SIPL 系列

低暗电流 DIP 封装 硅 PIN 光电二极管

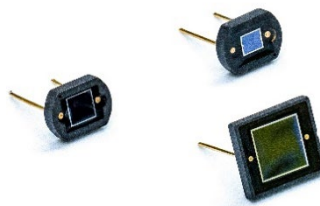

产品特点

- 320 ~ 1080nm 光谱响应范围
- 极低的暗电流
- 低结电容
- DIP 封装

应用场景

- 光电测量仪器
- 光学分析设备
- 光功率监测

产品结构 / 极限参数

产品型号 ¹	封装形式	窗口材料	感光面尺寸 (mm)	极限参数			
				储存温度 ² T _{stg} (°C)	工作温度 ² T _{opr} (°C)	焊接温度 T _{sol} (°C)	反向电压 V _R (V)
SIPL026026D1	DIP	环氧树脂	2.6×2.6	-20 to +80	-20 to +80	260(5s)	30
SIPL032032D1			3.2×3.2				
SIPL058058D1			5.8×5.8				
SIPL100100D1			10×10				10

注 1: 其他感光面积、窗口材料和管壳高度可定制, 请联系销售人员获取更多信息。

注 2: 无结露。

性能参数

产品型号	光谱响应 范围 λ(nm)	峰值响应 波长 λ _p (nm)	光响应 S(A/W)	暗电流 I _b (pA) V _R =10mV		终端电容 C _t (pF) V _R =0V, f=100kHz		上升时间 t _r (μs) V _R =0V, R _L =1kΩ	分流电阻 R _{sh} (GΩ) V _R =10mV		噪声等效功率 NEP (W/Hz ^{1/2})
				Typ.	Typ.	Max.	Typ.	Max.	Typ.	Min.	Typ.
SIPL026026D1	320~1080	780	0.40@560nm 0.46@633nm 0.52@780nm	5	20	70	100	0.16	0.5	2	5.7×10 ⁻¹⁵
SIPL032032D1				2.5	10	115	150	0.25	1	2	4.1×10 ⁻¹⁵
SIPL058058D1				5	20	400	450	0.9	0.5	2	5.7×10 ⁻¹⁵
SIPL100100D1				15	80	900	1000	2.0	1.2	0.7	9.6×10 ⁻¹⁵

上海派徠兹科贸有限公司

SHANGHAI LIGHT-CATCHER CO., LTD.

上海市杨浦区国霞路258号707-708室

RM 707-708, 258 Guoxia Road, Yangpu District, Shanghai P.R.C 200433

TEL: +86 21 51082420

www.lc-oe.com

➤ 光谱响应曲线

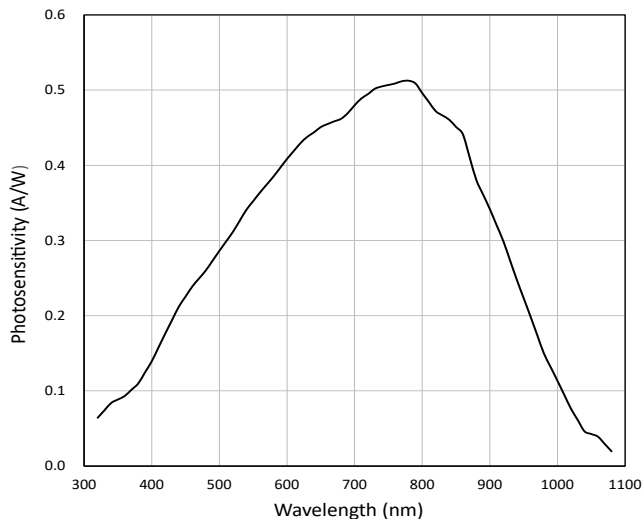

➤ 暗电流 vs 反向电压

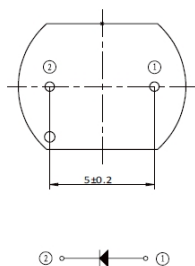
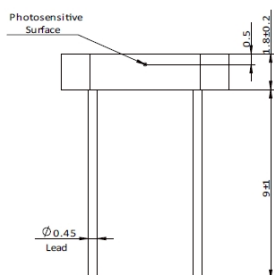
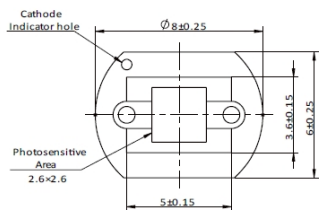
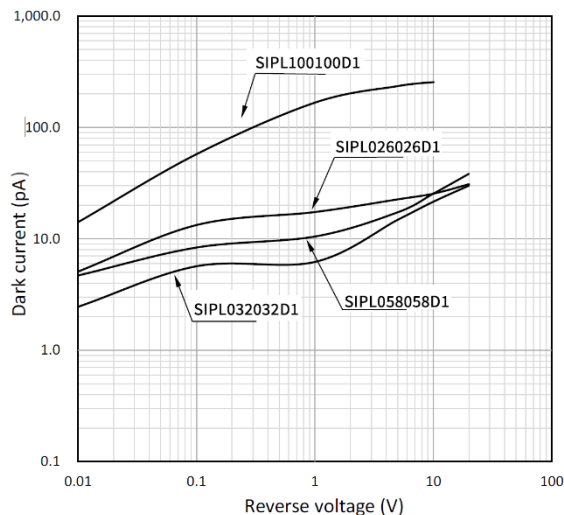

Note:
1. Tolerance unless otherwise noted:
±0.2 mm

SIPL026026D1

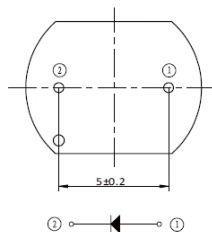
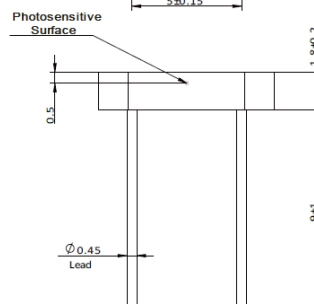
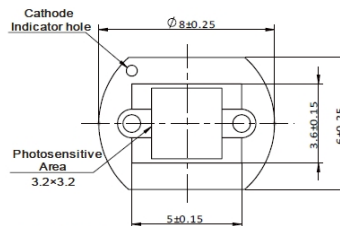

Note:
1. Tolerance unless otherwise noted:
±0.2 mm

SIPL032032D1

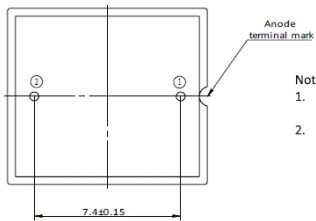
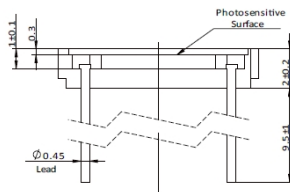
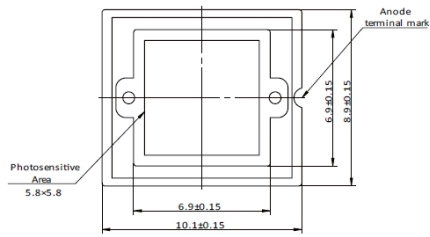

SIPL058058D1

- Note:
1. Tolerance unless otherwise noted: ± 0.2 mm
 2. The resin potting may extend a maximum of 0.1 mm above the upper surface of the package

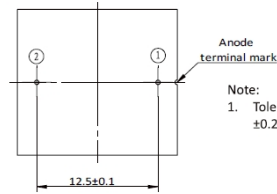
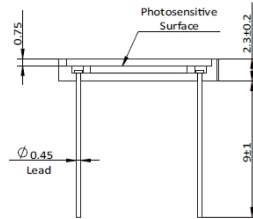
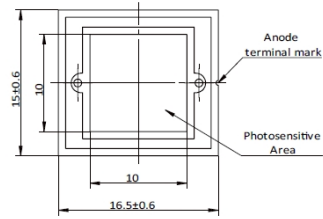

SIPL100100D1

- Note:
1. Tolerance unless otherwise noted: ± 0.2 mm

➤ **版本记录**

版本	日期	描述
V01	2024/07/11	增删型号